



INDUSTRIAL SHUTTER DOOR OPENER

AFFORDABLE | DURABLE | RELIABLE





KEY FEATURES INCLUDE

- 

MAINS POWER 240V / 415V VERSIONS
ECO HDS-2501: 1ph / ECO HDS-2503: 3ph
- 

EXTERNAL CONTROL UNIT
Easy, plug-in cable sets ensure easy installation.
Standard Up / Down / Stop buttons.
- 

EMERGENCY HAND CHAIN
Convenient operation of doors from the ground in a power outage.
- 

ELECTRONIC LIMITS
Absolute encoder system.
- 

HIGH DUTY CYCLE
30% Duty cycle, 20 min continuous max.
- 

AUTOMATIC SAFETY REVERSE (PE BEAMS)*
Stop and reverse automatically if beams are obstructed while the door is going down.
- 

AUTO CLOSE
can be set when safety system is installed.
- 

FOUR RELAY OUTPUTS FOR ADDITIONAL FUNCTION
Photocell or safety edge, alarm lamp, external button switch.



Compliant to Australian and New Zealand Standard AS/NZS 60335.2.95 with AS/NZS 60335.1

ACCESSORIES INCLUDED

- › **AVIATION PLUG:** Standard with 5m optional for 8m/10m/15m*
- › **STANDARD SHAFT:** 25.4 – 31.75mm shaft with keys and circlip

ADD-ON ACCESSORIES*

- › **MOUNTING PLATE SET**
- › **MOUNTING CONVERTER**
- › **DRIVE SPROCKET:** 31.75mm, 14T /16T /18T available in 10B
- › **ROLLER CHAIN:** available in 10B
- › **2 REMOTES:** 433.92MHz Rolling code with security

* optional extra

INDUSTRIAL ROLLER DOOR OPENER

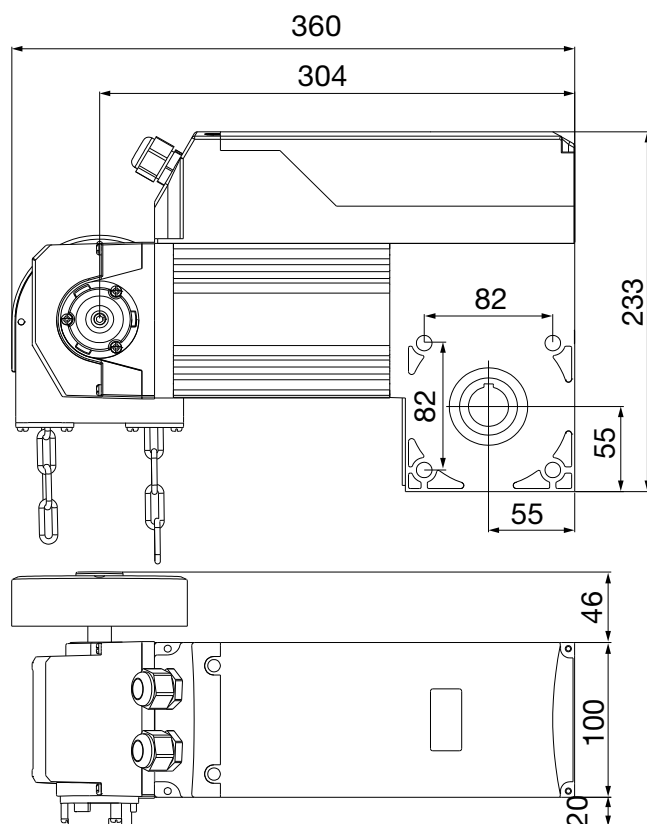

TECHNICAL SPECIFICATIONS

	ECO HDS-2501	ECO HDS-2503
Power Supply	AC 240V 1ph	AC 415V 3ph
Motor Power	300W	400W
Output Torque	50N.m	80N.m
Max. Door Size (Spring balanced)	25m ²	25m ²
Output Speed		32rpm
Output Shaft Aperture		ø31.75mm
Max. Rotation		28
Net Weight		12kg
Dimension		100mm x 233mm x 360mm
Environment Temperature		-20°C ~ +50°C
Duty Cycle		30% Duty Cycle. 20 mins Continuous max.
IP Rating		IP54
Gear ratio (57T/14T)		Up to 25m ² 4:1
Gear ratio (37T/14T)		Up to 18m ² 2.7:1